

TORQUE MULTIPLIER

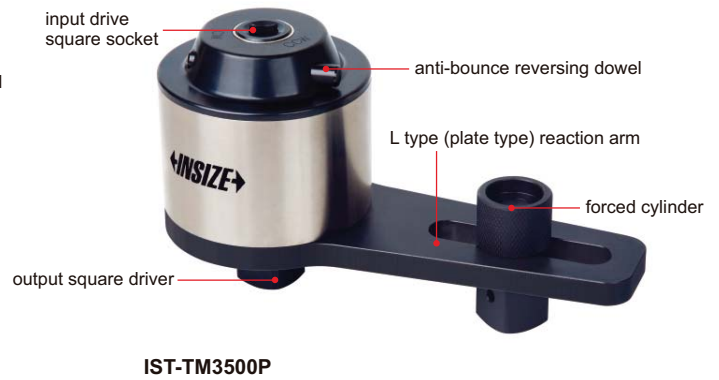

IST-TM2000



IST-TM3500P

- Suitable for occasions where space is limited and external power sources can not be used
- High-efficiency planetary gear sets input small torque, output high torque
- Torque multiplier output torque accuracy is $\pm 5\%$
- Alloy steel, long service life
- The position of the force cylinder (plate type) can be adjusted according to working conditions
- According to user requirements, special reaction arm can be made



Example: the maximum output torque is 738ft.lb (torque ratio is 1:4), the maximum input torque can not exceed 184.5ft.lb, otherwise it will cause damage to the torque multiplier

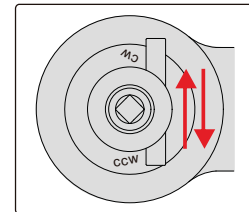
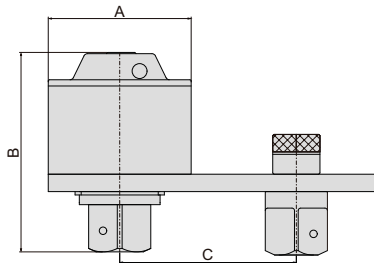
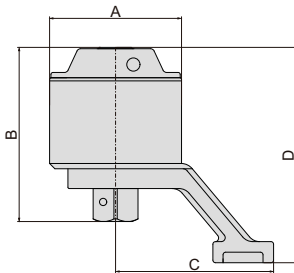

After reaching the target torque, toggle the anti-bounce reversing dowel, turn the wrench in the anticlockwise direction, then remove the wrench and torque multiplier

BEVEL TYPE TORQUE MULTIPLIER

Part No.	Capacity	Accuracy	Torque ratio	Square socket	Square driver	Dimension (A×B×C×D)	For bolt	For nut	Weight
IST-TM1000	738ft.lb	±5%	1:4	1/2"	1"	3.23x3.88x3.82x4.82"	9/16~1-1/8	15/16~1-13/16	4.63lb
IST-TM2000	1475ft.lb		1:13	1/2"	1"	3.23x4.72x4.13x5.79"	7/8~1-3/8	1-7/16~2-3/16	6.94lb
IST-TM3500	2582ft.lb		1:16	1/2"	1"	3.86x5.16x4.72x6.42"	1-1/4~1-3/4	2~2-3/4	10.80lb
IST-TM5500	4057ft.lb		1:20.5	1/2"	1 1/2"	4.53x6.44x5.40x7.83"	1-1/2~2	2-3/8~3-1/8	17.86lb
IST-TM7500	5532ft.lb		1:23	1/2"	1 1/2"	5.00"x6.81x5.75x8.46"	1-5/8~2-1/2	2-9/16~3-7/8	23.37lb
IST-TM10000	7376ft.lb		1:28	1/2"	1 1/2"	5.55x6.70x6.46x9.37"	2~3	3-1/8~4-5/8	30.86lb

PLATE TYPE TORQUE MULTIPLIER

Part No.	Capacity	Accuracy	Torque ratio	Square socket	Square driver	Dimension (A×B×C)	For bolt	For nut	Weight
IST-TM1000P	738ft.lb	±5%	1:4	1/2"	1"	3.23x3.82x(3.02~5.01)"	9/16~1-1/8	15/16~1-13/16	5.29lb
IST-TM2000P	1475ft.lb		1:13	1/2"	1"	3.23x4.72x(3.65~5.09)"	7/8~1-3/8	1-7/16~2-3/16	7.72lb
IST-TM3500P	2582ft.lb		1:16	1/2"	1"	3.86x5.04x(4.04~5.72)"	1-1/4~1-3/4	2~2-3/4	11.02lb
IST-TM5500P	4057ft.lb		1:20.5	1/2"	1 1/2"	4.53x6.18x(5.28~6.53)"	1-1/2~2	2-3/8~3-1/8	19.18lb
IST-TM7500P	5532ft.lb		1:23	1/2"	1 1/2"	5.00x6.61x(5.47~7.52)"	1-5/8~2-1/2	2-9/16~3-7/8	25.80lb
IST-TM10000P	7376ft.lb		1:28	1/2"	1 1/2"	5.55x7.32x(5.67~8.50)"	2~3	3-1/8~4-5/8	33.51lb
IST-TM15000P	11063ft.lb		1:50	3/4"	2 1/2"	6.14x9.69x(6.11~9.64)"	2-1/4~3-1/4	3-1/2~5	53.13lb
IST-TM20000P	14751ft.lb		1:76	3/4"	2 1/2"	6.70x10.39x(6.45~10.88)"	2-3/4~4	4-1/4~6-1/8	61.29lb