

GAGE BLOCK ACCESSORY

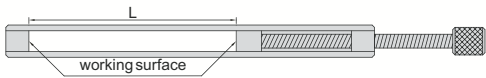

6881-A3



| Part No. | Name | Clamping range*(L) |
|-----------|--------|--------------------|
| 6881-A1 | holder | 0-1" |
| 6881-A2 | holder | 1-2" |
| 6881-A3 | holder | 2-4" |
| 6881-A4 | holder | 4-8" |
| 6881-A5 | holder | 8-12" |
| 6881-A6** | holder | 12-20" |

* The actual clamping range should deduct the width of jaws

** Not suitable for base 6881-BE



6881-C

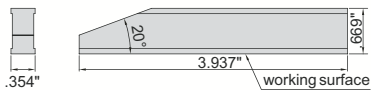

| Part No. | Name | Remark |
|----------|-----------|-----------------------------------|
| 6881-C | plain jaw | made of carbide, supplied in pair |



6881-D

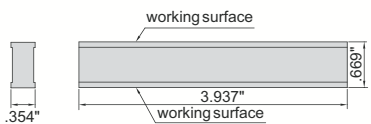

| Part No. | Name | Remark |
|----------|--------------|-----------------|
| 6881-D | parallel jaw | made of carbide |



6881-BE

| Part No. | Name |
|----------|------|
| 6881-BE | base |

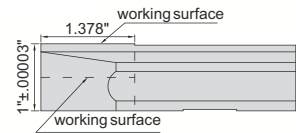

6881-E2E

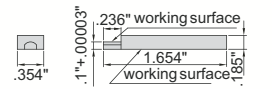

6881-E1E

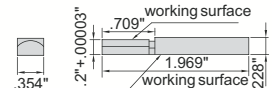

6881-E2E

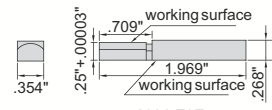

6881-E3E

| Part No. | Name | Size | Remark |
|----------|----------------|------|-----------------------------------|
| 6881-E1E | half round jaw | .1" | made of carbide, supplied in pair |
| 6881-E2E | half round jaw | .2" | made of carbide, supplied in pair |
| 6881-E3E | half round jaw | .25" | made of carbide, supplied in pair |



6881-F

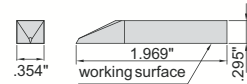

| Part No. | Name | Remark |
|----------|---------|-----------------|
| 6881-F | scriber | made of carbide |



6881-G

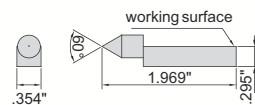

| Part No. | Name | Remark |
|----------|--------------|----------------------------|
| 6881-G | centre point | the tip is made of carbide |



6881-H

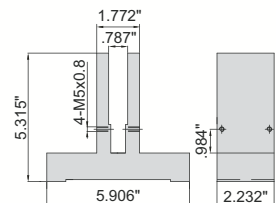

| Part No. | Name | Remark |
|----------|-----------------|------------------|
| 6881-H | base for holder | supplied in pair |

To be continued

Continued from previous page

GAGE BLOCK ACCESSORY SET

| Part No. | Mark |
|-----------|-----------------------------------|
| 6881-S17E | 17pcs (including the below items) |

| | |
|-------------------------------------|--------|
| holder, 0-1" (part no. 6881-A1) | 1pc |
| holder, 1-2" (part no. 6881-A2) | 1pc |
| holder, 2-4" (part no. 6881-A3) | 1pc |
| holder, 4-8" (part no. 6881-A4) | 1pc |
| holder, 8-12" (part no. 6881-A5) | 1pc |
| base (part no. 6881-BE) | 1pc |
| plain jaw (part no. 6881-C) | 1 pair |
| parallel jaw (part no. 6881-D) | 1pc |
| half round jaw, (part no. 6881-E1E) | 1 pair |
| half round jaw, (part no. 6881-E2E) | 1 pair |
| half round jaw, (part no. 6881-E3E) | 1 pair |
| scriber (part no. 6881-F) | 1pc |
| centre point (part no. 6881-G) | 1pc |



6881-S17E

application

| | | |
|--|--|---|
| <p>(plain jaw+holder) set zero</p> | <p>(base+holder+scriber) measure height or scribe</p> | <p>(plain jaw+holder) (plain jaw+holder+base for holder)</p> |
| <p>(half round jaw+holder) measure size A</p> | <p>(plain jaw+parallel jaw+holder) Go and No Go inspection</p> | |
| <p>(half round jaw+holder) measure inside diameter</p> | <p>(scriber+centre point+holder) scribe circle</p> | |