

OPTIONAL ACCURACY:  
CLOCKWISE:  $\pm 1\%$   
COUNTER-CLOCKWISE:  $\pm 2\%$   
ONLY FOR RANGE 6~850N.m

## DIGITAL TORQUE WRENCHES

INSPECTION  
CERTIFICATE



VIDEO



IST-W135A  
type A

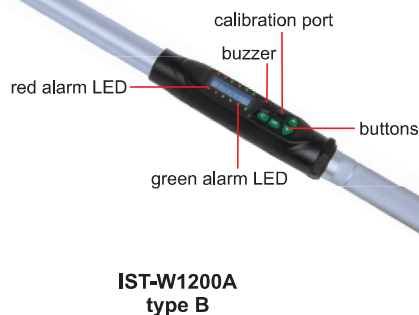
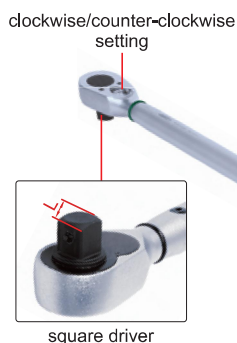

IST-W1200A  
type B

- Ratchet head
- Clockwise and counter-clockwise operation
- Unit: N.m, in.lb, ft.lb, kg.cm
- Peak and track working mode
- Target torque value can be set, with audible and visible alarm:
  - Green LED light on and buzzer sounds when torque value is 90%~100% of target torque
  - Both green and red LED light on and buzzer sounds when target torque value is reached
- Power off automatically in 5 minutes without any operations
- Non-slip grip handle
- With damp record
- With overload record (once the torque reaches 110% of the maximum range)

### SPECIFICATION

Code	Type	Range	Accuracy	Resolution	Square driver (L)	Power supply	Length	Weight
IST-W30A	A	6~30N.m	clockwise: $\pm 2\%$ counter-clock wise: $\pm 3\%$	0.01N.m	1/4"	2×AA batteries, for 110 hours working	390mm	760g
IST-W60A		12~60N.m		0.01N.m	3/8"		415mm	940g
IST-W135A		27~135N.m		0.1N.m	3/8"		415mm	940g
IST-W200A		40~200N.m		0.1N.m	1/2"		530mm	1340g
IST-W340A		68~340N.m		0.1N.m	1/2"		650mm	1540g
IST-W500A		100~500N.m		0.1N.m	3/4"		950mm	2950g
IST-W850A		170~850N.m		0.1N.m	3/4"		1220mm	4260g
IST-W1200A*	B	240~1200N.m	clockwise: $\pm 2.5\%$ counter-clock wise: $\pm 3.5\%$	1N.m	1"		1785mm	9000g
IST-W1500A*		300~1500N.m		1N.m	1"		1785mm	9000g
IST-W2000A*		400~2000N.m		1N.m	1"		1785mm	10420g

\* Without torque units: in.lb, kg.cm

### OPTIONAL ACCESSORY

Calibration cable IST-W-CABLE